

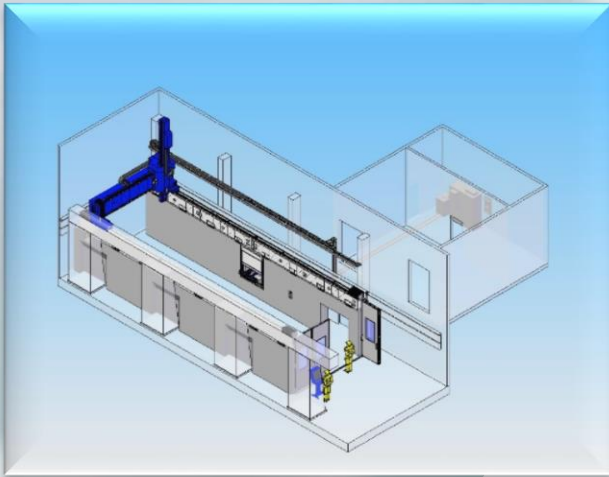

## LaborWind

LaborWind is the machining center designed for those applications requiring the biggest working fields, especially for the vertical "Z" axis.



### Machine structure

The mobile crossbeam, "suspended" on lateral steel or reinforced concrete structures, allows to cover very large working areas without overload the basic structure of the machine.

	Axis / Assi	Speed / Velocità
X	8.000 - 10.000 -	80 m/1'
	15.000 - 20.000 -	
	30.000 - 40.000 mm	
Y	4.000 - 5.000 - 6.000	80 m/1'
	6.500 - 7.500 - 8.000	
Z	2.500 - 3.000 - 3.500	40 m/1'
	4.000 - 4.500 - 8.000	
A	+/- 120°	40 m/1'
C	+/- 365°	30 m/1'



### Working Unit

Two different working heads and various electro-spindles (power 10, 12, 15, 22, 42 kW, S1) makes LaborWind configurable for the specific materials and milling needs.



With longer longitudinal axis strokes versions the machine can also be supplied with double mobile crossbeam and independent working unit, thus to double the production capacity.





### Numeric Control

**CNC SIEMENS 840 D SL** *HIGH PERFORMANCE* assures the highest performances in terms of accuracy and working speed, thanks to the advantages given to the machine dynamic.



### Tool setter

Thanks to its precise measuring mechanism, the Tool Setter reliably determines length and radius of the tool, measures single edged cutters and detects broken tools. Measuring can be made both statically and dynamically. A specific system allows the "A" and "C" rotating axes alignment, after a heavy working cycle or in case of accidental collision of the working head.

The device is mounted on a sliding support, with pneumatic movement in order not to restrict the working area.



### Tool Magazine

Different tool magazines, linear or rotating type, with 8, 10 or 12 positions, can be installed on the lateral side of the machine.

The magazine is protected by a pneumatic covering, activated by NC function, to prevent from the dust and chips to damage the tool-holders.

Numerical control / Controllo Numerico	
Siemens	840 D SL
Tools Magazine / Magazzino Utensili	
Linear ATC <i>Magazzino lineare</i>	8 - 10 pos.
Rotating ATC <i>Magazzino rotante</i>	10 - 12 - 16 pos.



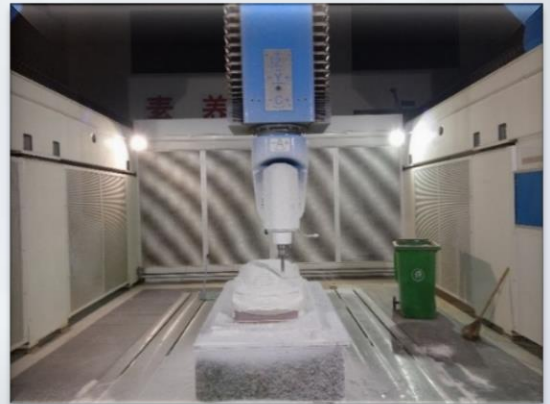

**LaborWind** is the best solution for the machining of large composite parts and models, such as wind turbines, automotive components, boat plugs.



Composites / Compositi	✓	Wind / Eolico	✓
Resin / Resine	✓	Marine / Nautica	✓
Wood / Legno	✓	Aerospace	✓
Aluminum / Alluminio	✓		

✓ Best application / Miglior applicazione  
 ✓ Suggested application / Applicazione consigliata





Ciserano (BG) - Italy



Levate (BG) - Italy



Vigevano (PV) - Italy



Columbus - (OHIO) - USA



## THERMOFORMING

### HOUSEHOLD APPLIANCES INDUSTRIAL

- THERMOFORMING MACHINES
- PUNCHING PRESSES
- PUNCHING MOLDS
- SHEET SINGLE STATION
- COIL UNWINDER
- AUTOMATIC LOADER

### THERMOFORMING MOLDS

## PRESSES

- COMPRESSION PRESSES
- INJECTION PRESSES
- RECONDITIONING

## CNC CENTRES

- CNC MILLING
- WATERJET CUTTING
- LASER CUTTING

## ENGINEERING

- TURNKEY PLANTS
- SPRAYING UNITS
- WORKING AREAS



Via Liegi, 2  
24040 CISERANO - Zingonia (BG), Italy  
Tel +39 035 882567  
Fax +39 035 885051  
commerciale@comispa.it  
www.comispa.it

